

INVESTMENT MANAGEMENT ASSOCIATES, INC.

Currently Representing

 **car sales**

*Seeking Multiple Sites in Miami-Dade
Broward & Palm Beach Counties*



REQUIREMENTS:

- ◆ Size: 2 - 5 Acres
- ◆ Purchase or Lease
- ◆ High Visibility
- ◆ Easy Accessibility
- ◆ Near Competitors a Plus
- ◆ Sale of Cars & Trucks

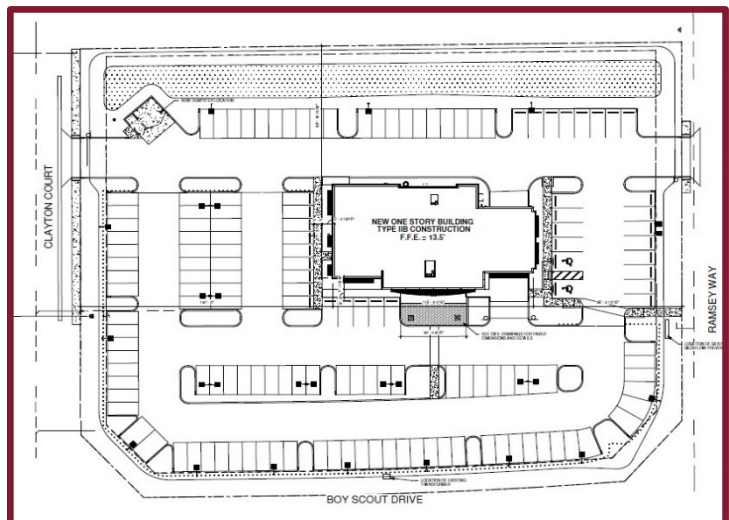

SUBMIT SITES TO:

Russell Levene: rlevene@ima-re.com

Andrew Pearl: apearl@ima-re.com

2151 S. Le Jeune Road, Suite 202
Coral Gables, FL 33134

T: 305.661.0110 ◆ www.ima-re.com ◆ F: 305.661.7803



Any information herewith is obtained from sources we consider reliable. However, we are not responsible for misstatement of facts, errors, omissions, prior sale, withdrawal from market, modification of mortgage commitment, terms and conditions or change in price without notice. The information supplied herein is for informational purposes only and shall not constitute a warranty of assurance that said information is correct. Any person intending to rely upon the information supplied herein should verify said information independently.